

THE EXCHANGE

FALL 2015

KEEPING YOUR PROJECT ON SCHEDULE



TP Mechanical understands that time is a critical factor in commercial construction. Our team offers several services to keep your project running on track. We collaborate with our customers and provide innovative solutions and creative problem-solving that drive down costs and shortens timelines.

Fabrication in our ISO 9001:2008-certified fab shop is one pivotal element in our ability to improve construction schedules.

We can provide:

- Custom designs using BIM and CAD software technologies that provide accurate, up-to-the-minute information as the project evolves
- In-house pre-fabrication to improve efficiency
- Products that include overhead group racking, equipment skid packages, hanger assemblies

Fabrication allows us to accelerate the field installation to meet demanding project schedules. Read more about our process from design to installation on our website.

PROJECT PROFILE

Dunnhumby USA

TP Mechanical was hired to install plumbing for the new 84.51° Centre building in downtown Cincinnati, formerly known as dunnhumbyUSA headquarters. This \$4.8 million project provided an interesting twist for our construction team.

The building on Fifth and Race streets was constructed with both 84.51° and the Cincinnati Center City Development Corporation (3CDC) as owners. The level of the building owned by 3CDC housed all of the main water supplies, and they were working with a different construction staff.

To minimize TP's involvement on this floor, most of our work took place in our ISO-certified fabrication facility. Work completed at the facility included building water heaters, carrier groups for the restrooms and the piping from the heaters to feed to the 84.51° levels.

The project took more than a year to complete, with 84.51° occupying floors five through nine and extra expansion space for floors two through four. An official ribbon-cutting ceremony was held at the building in April 2015.

View photos our work at 84.51° Centre in the portfolio section of our website.

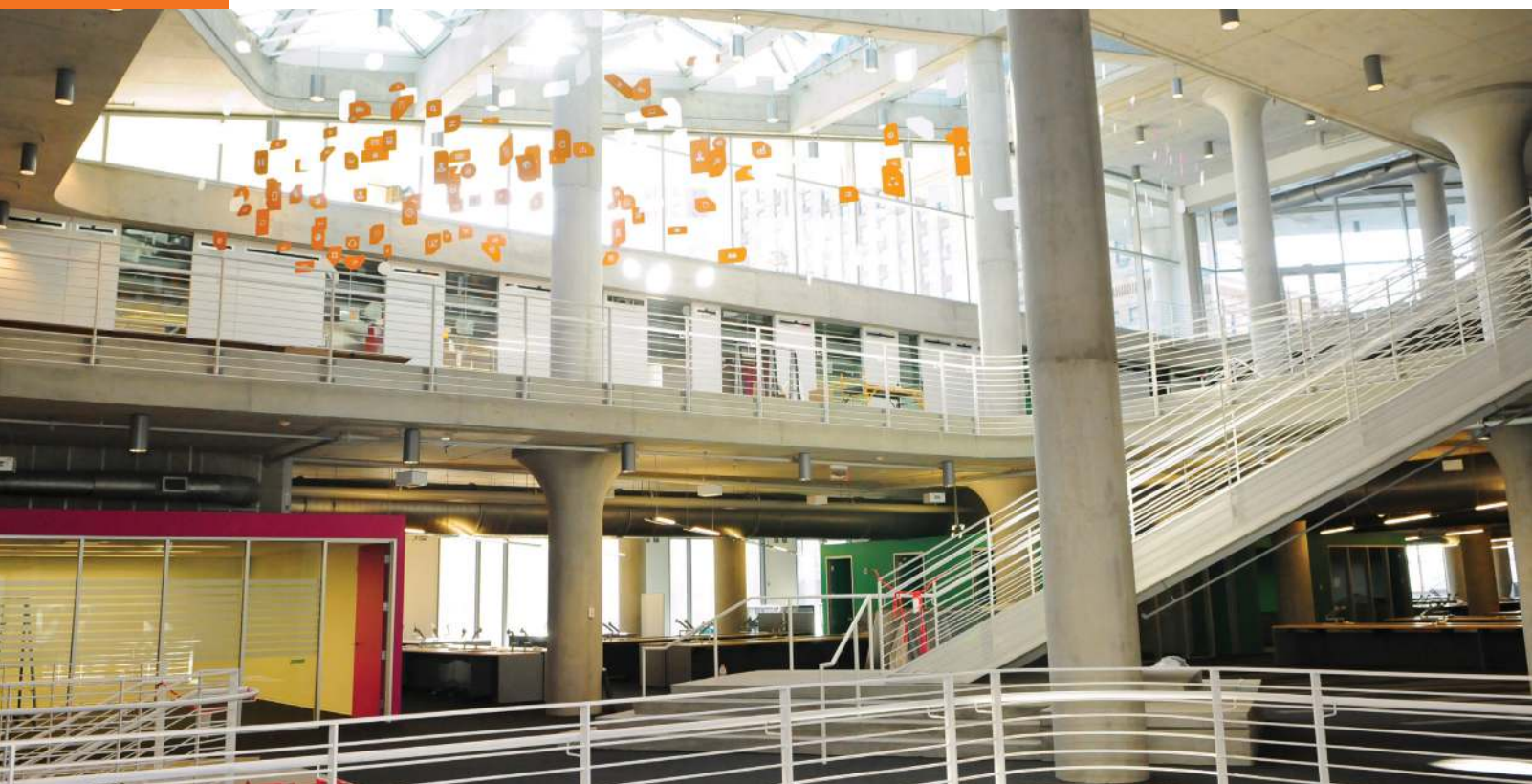

SAFETY: LADDERS & STAIRWAYS

There are some hazards on the job site that seem obvious and some that need a little more attention from workers.

While the importance of ladder safety is communicated heavily at job sites, there are some workers and managers who unknowingly neglect to speak about the dangers of stairways.

According to OSHA, there are more than 24,000 injuries and as many as 36 fatalities per year due to falls on stairways and ladders used in construction.

The good news is that many of the accidents around ladders and stairways are preventable when the proper measures are taken prior to starting a job.

With Ladders:

- Use the correct ladder for the task
- Never load ladders beyond the manufacturer's rated capacity
- Ensure that metal ladders are kept away from electrical work and overhead power lines
- Have a worker partner inspect for any defects
- Look for structural damage, grease or other slippery contaminant

With Stairways

- Stairways must be free of dangerous objects, debris and materials
- Cover stairs with threads to avoid a slippery surface
- Stairways with four or more risers or that rise more than 30 inches need to have a least one handrail
- Stair handrails must be free of hazards like splinters and nails

You can read more about TP Mechanical's commitment to safety practices out in the field and inside of the shop on our website.



COMMUNITY SPOTLIGHT

LLS Light the Night Walk



TP Mechanical is proud to once again support the Leukemia & Lymphoma Society Light the Night Walk. The walk brings together communities to honor blood cancer

survivors, and our team is proud to shine light on this cause.

This year, our goal is to collect \$5,000 to help patients with Leukemia or Lymphoma to increase their rate of survival. The walk takes place on October 15, 2015 at Sawyer Point and October 17, 2015 at Whitaker Bank Park in Lexington, KY.

Without your efforts, LLS could not fund the research of such treatments as targeted therapies that zero in on cancer cells and kill them or immunotherapy drugs that use a patient's own immune system to kill cancer.

Registration is now open and you can join our team by visiting our website.

**DON'T FORGET TO VISIT
OUR NEW WEBSITE:
TPMECHANICAL.COM**

PREFAB SPOTLIGHT:

Christ Hospital Modular Bathrooms

TP Mechanical partnered with PIVOTek on a new 332,000-square-foot facility at The Christ Hospital.

The \$4.8 million contract for this project was to develop and install 90 modular bathroom units, also called pods. This was the first project to utilize bathroom pods installed on a level grade, thanks to PIVOTek's innovative flooring technology. The floor will be finished after the pods are in place to avoid elevation issues.

The expansion, located just south of the main hospital, will connect to the current hospital and provide access for patients and visitors.

Construction began on the \$265 million expansion in June 2012. This new center will enable Christ Hospital to be the only local, and one of the few in the country, single-purpose hospital facility focused on comprehensive orthopedic and spine services and research.

View photos of our fabrication work for The Christ Hospital on our website in the portfolio section.



CHANGE THE WAY YOU BUILD.

